

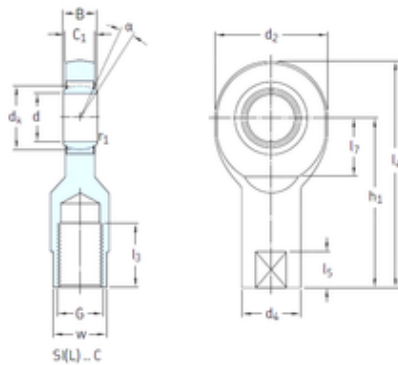

SKF SI20C plain bearings



Bearing No. SI20C

Bore Diameter	20 mm
d	20 mm
d2	54 mm
d3	30 mm
d4	28 mm
dk	29 mm
h1	77 mm
l4 max.	106 mm
l5	16 mm
l7 min.	24 mm
r1 min.	0,3 mm
B	16 mm
C1 max	13,5 mm
w	24 Tolerance h14
Thread (G)	M20x1,5 Tolerance 6H
Angle	9 °
Weight	0,35 Kg
Basic dynamic load rating (C)	31,5 kN

SI20C Bearing 2D drawings and 3D CAD models