

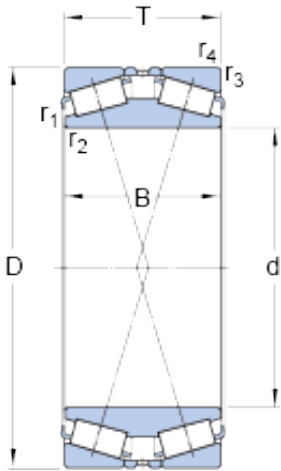

Guangzhou Wangli Auto Parts Co., Ltd.



368.3 mm x 596.9 mm x 158.75 mm SKF 331905 tapered roller bearings

Bearing No. 331905

331905 Bearing 2D drawings and 3D CAD models

Size	596.9x368.3x165.1 mm
Bore Diameter	596,9 mm
Outer Diameter	368,3 mm
Width	165,1 mm
d	368.3 mm
D	596.9 mm
T	165.1 mm
B	158.75 mm
r _{1,2} - min.	6.4 mm
r _{3,4} - min.	6.4 mm
Basic dynamic load rating - C	3080 kN
Basic static load rating - C ₀	5850 kN
Fatigue load limit - P _u	465 kN
Comparative radial load rating - C _F	750 kN
Comparative axial load rating - C _{Fa}	305 kN
Thrust factor - K	1.41
Calculation factor - e	0.4
Calculation factor - Y ₁	1.7
Calculation factor - Y ₂	2.5
Calculation factor - Y ₀	1.6
Mass bearing	160 kg
Design variant/feature	TDI/GWIY2



Guangzhou Wangli Auto Parts Co., Ltd.

d_1	427 mm
D_1	518 mm
$r_{1,2}$ min.	6.4 mm
$r_{3,4}$ min.	6.4 mm
Basic dynamic load rating C	3080 kN
Basic static load rating C_0	5850 kN
Fatigue load limit P_u	465 kN
Calculation factor e	0.4
Calculation factor Y_1	1.7
Calculation factor Y_2	2.5
Calculation factor Y_0	1.6
Comparative radial load rating C_F	750 kN
Comparative axial load rating C_{Fa}	305 kN
Thrust factor K	1.41