

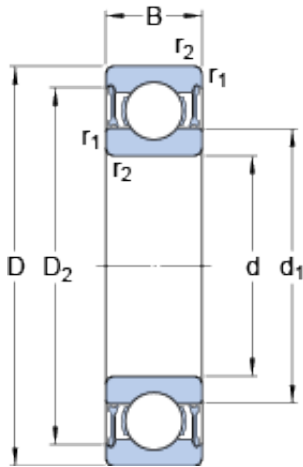

## Guangzhou Wangli Auto Parts Co., Ltd.



61904-2RZ Bearing 2D drawings and 3D CAD models

20 mm x 37 mm x 9 mm SKF 61904-2RZ deep groove ball bearings

Bearing No. 61904-2RZ

Size	37x20x9 mm
Bore Diameter	37 mm
Outer Diameter	20 mm
Width	9 mm
d	20 mm
D	37 mm
B	9 mm
d <sub>1</sub>	25.55 mm
D <sub>2</sub>	32.7 mm
r <sub>1,2</sub> - min.	0.3 mm
d <sub>a</sub> - min.	22 mm
d <sub>a</sub> - max.	25.5 mm
D <sub>a</sub> - max.	35 mm
r <sub>a</sub> - max.	0.3 mm
Basic dynamic load rating - C	6.4 kN
Basic static load rating - C <sub>0</sub>	3.6 kN
Fatigue load limit - P <sub>u</sub>	0.156 kN
Reference speed	43000 r/min
Limiting speed	20000 r/min
Calculation factor - k <sub>r</sub>	0.02
Calculation factor - f <sub>0</sub>	14.7
Category	Single Row Ball Bearings
Inventory	0.0
Manufacturer Name	SKF



## Guangzhou Wangli Auto Parts Co., Ltd.

Minimum Buy Quantity	N/A
Weight / Kilogram	0.041
EAN	7316577121967
Product Group	B00308
Enclosure	2 Seals
Precision Class	ABEC 1   ISO P0
Maximum Capacity / Filling Slot	No
Rolling Element	Ball Bearing
Snap Ring	No
Internal Special Features	No
Cage Material	Steel
Enclosure Type	Non-Contact Seal
Internal Clearance	C0-Medium
Inch - Metric	Metric
Long Description	20MM Bore; 37MM Outside Diameter; 9MM Outer Race Diameter; 2 Seals; Ball Bearing; ABEC 1   ISO P0; No Filling Slot; No Snap Ring; No Internal Special Features
Category	Single Row Ball Bearing
UNSPSC	31171504
Harmonized Tariff Code	8482.10.50.68
Noun	Bearing
Keyword String	Ball
Manufacturer URL	<a href="http://www.skf.com">http://www.skf.com</a>
Manufacturer Item Number	61904-2RZ
Weight / LBS	0.09
Outer Race Width	0.354 Inch   9 Millimeter
Bore	0.787 Inch   20 Millimeter
Outside Diameter	1.457 Inch   37 Millimeter
bore diameter:	20 mm



## Guangzhou Wangli Auto Parts Co., Ltd.

static load capacity:	3.65 kN
outside diameter:	37 mm
precision rating:	Not Rated
overall width:	9 mm
finish/coating:	Uncoated
bore type:	Round
cage material:	Steel
closure type:	Double Sealed
outer ring width:	9 mm
row type & fill slot:	Single Row Non-Fill Slot
fillet radius:	0.3 mm
internal clearance:	C0
maximum rpm:	20000 RPM
operating temperature range:	-40 to +210 ° F
series:	61
dynamic load capacity:	6.37 kN
$d_1$	25.55 mm
$D_2$	32.7 mm
$r_{1,2}$ min.	0.3 mm
$d_a$ min.	22 mm
$d_a$ max.	25.5 mm
$D_a$ max.	35 mm
$r_a$ max.	0.3 mm
Basic dynamic load rating C	6.37 kN
Basic static load rating $C_0$	3.65 kN
Fatigue load limit $P_u$	0.156 kN
Calculation factor $k_r$	0.02
Calculation factor $f_0$	14.7
Mass bearing	0.038 kg